



## **Exercises in Solid Works 2013**

### **Modelling the LEGO Human**

**Christensen, Georg Kronborg**

*Publication date:*  
2014

*Document Version*  
Publisher's PDF, also known as Version of record

[Link back to DTU Orbit](#)

*Citation (APA):*  
Christensen, G. K. (2014). *Exercises in Solid Works 2013: Modelling the LEGO Human*. Polyteknisk Boghandel og Forlag.

---

#### **General rights**

Copyright and moral rights for the publications made accessible in the public portal are retained by the authors and/or other copyright owners and it is a condition of accessing publications that users recognise and abide by the legal requirements associated with these rights.

- Users may download and print one copy of any publication from the public portal for the purpose of private study or research.
- You may not further distribute the material or use it for any profit-making activity or commercial gain
- You may freely distribute the URL identifying the publication in the public portal

If you believe that this document breaches copyright please contact us providing details, and we will remove access to the work immediately and investigate your claim.

# Exercises in Solid Works 2013

Modelling the LEGO Human

Georg K. Christensen

Danmarks  
Tekniske  
Universitet

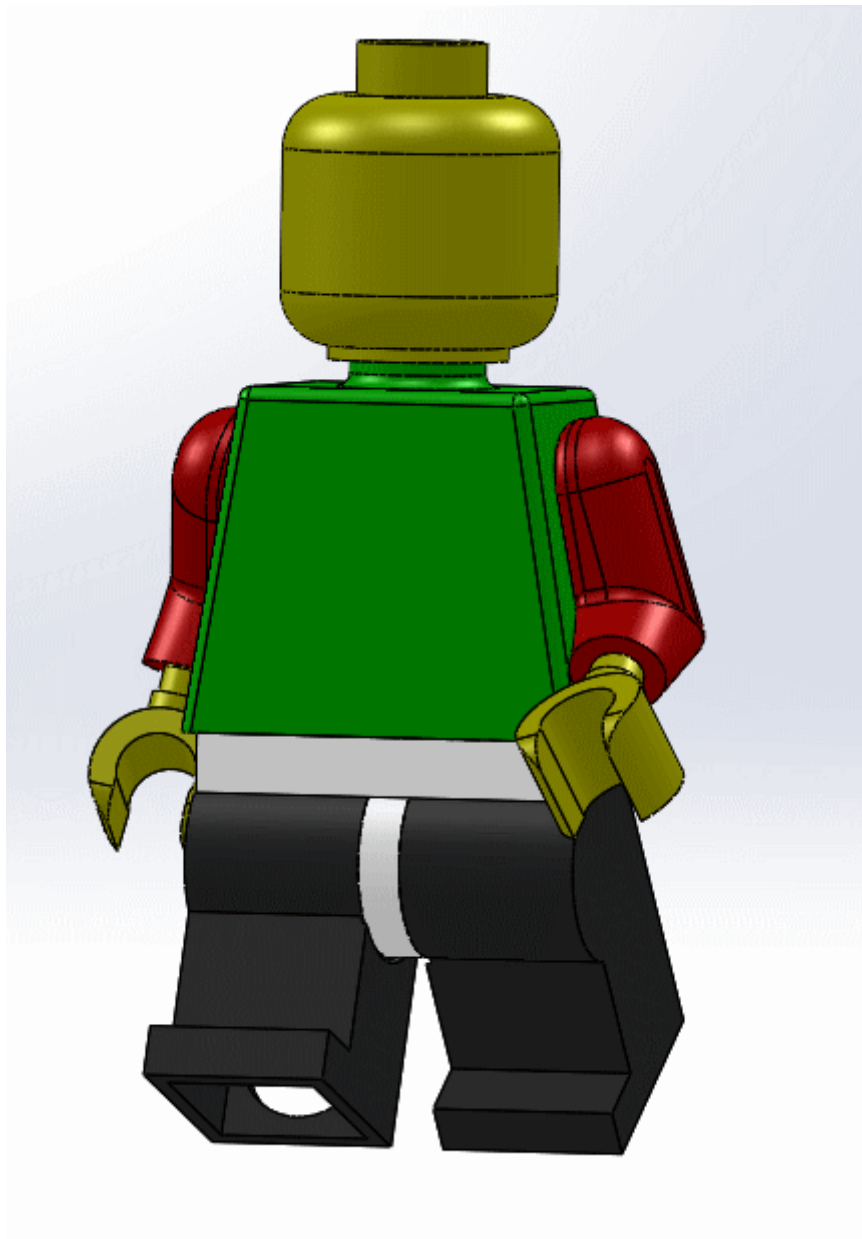

Institut for  
Mekanisk  
Teknologi

**MEK**

Konstruktion &  
Produktudvikling

Publikation 754  
Januar  
2014